

Subject to due diligence etc.

rev	amendments	by	date
A	Kitchen fittings added.	PH	17.05.13
B	Building size reduced.	PH	18.10.14
C1	Construction issue. Internal store rooms deleted. Foundation details added. Ash tree retained. Chimney deleted.	PH	06.01.15

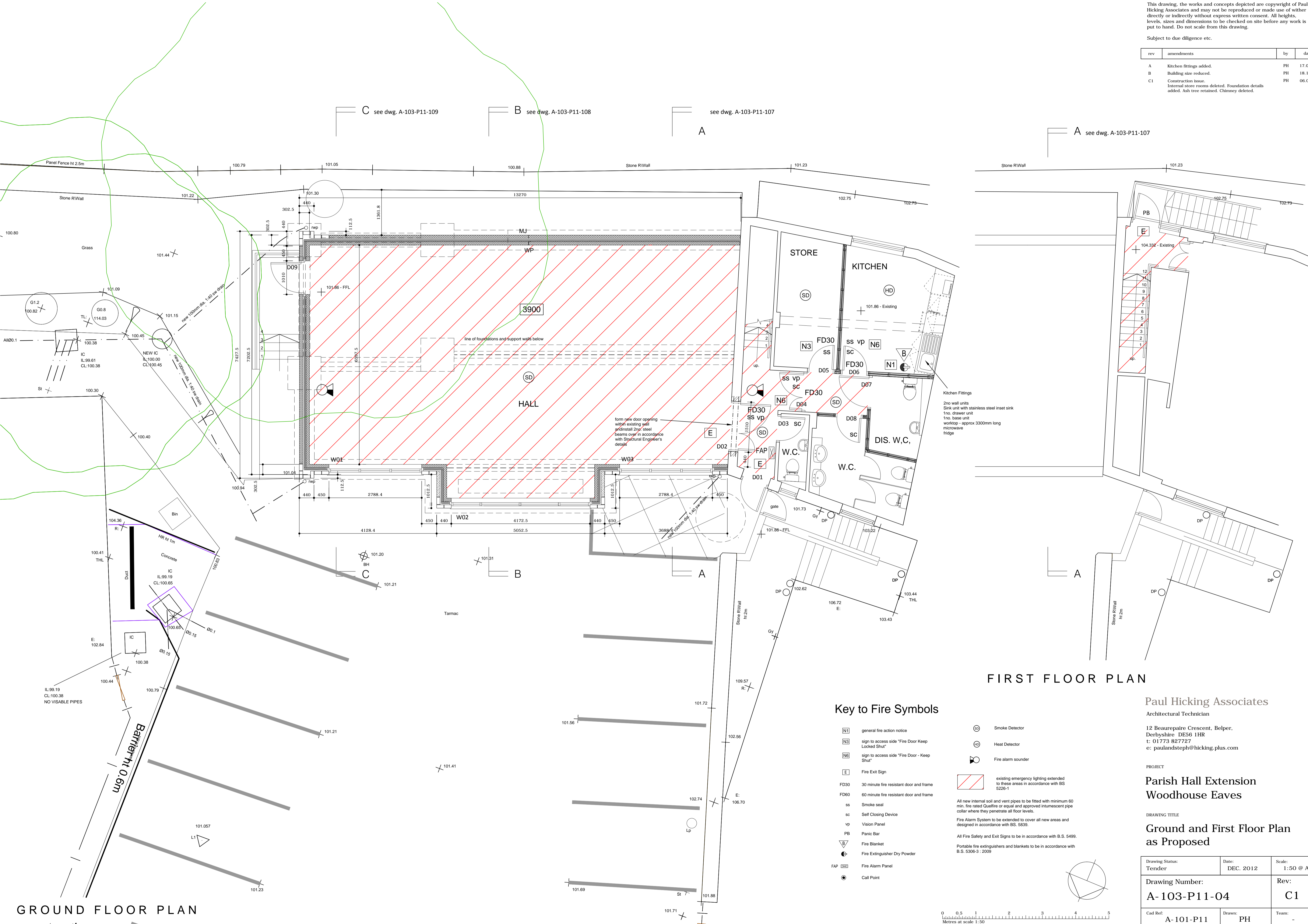

GROUND FLOOR PLAN

FIRST FLOOR PLAN

Key to Fire Symbols

- [N1] general fire action notice
 - [N3] sign to access side "Fire Door Keep Locked Shut"
 - [N6] sign to access side "Fire Door - Keep Shut"
 - [E] Fire Exit Sign
 - FD30 30 minute fire resistant door and frame
 - FD60 60 minute fire resistant door and frame
 - ss Smoke seal
 - sc Self Closing Device
 - vp Vision Panel
 - PB Panic Bar
 - Fire Blanket
 - Fire Extinguisher Dry Powder
 - FAP Fire Alarm Panel
 - Call Point
 - Smoke Detector
 - Heat Detector
 - Fire alarm sounder
 - existing emergency lighting extended to these areas in accordance with BS 5226-1
- All new internal soil and vent pipes to be fitted with minimum 60 min. fire rated Quelfire or equal and approved intumescent pipe collar where they penetrate all floor levels.
- Fire Alarm System to be extended to cover all new areas and designed in accordance with BS. 5839.
- All Fire Safety and Exit Signs to be in accordance with B.S. 5499.
- Portable fire extinguishers and blankets to be in accordance with B.S. 5306-3 : 2009

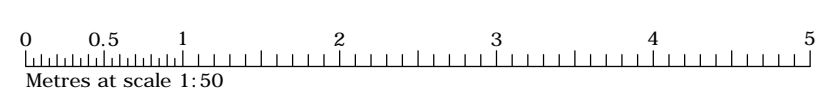

Paul Hicking Associates
Architectural Technician

12 Beaurepaire Crescent, Belper,
Derbyshire DE56 1HR
t: 01773 827727
e: paulandsteph@hicking.plus.com

PROJECT
**Parish Hall Extension
Woodhouse Eaves**

DRAWING TITLE
**Ground and First Floor Plan
as Proposed**

Drawing Status: Tender	Date: DEC. 2012	Scale: 1:50 @ A1
Drawing Number: A-103-P11-04	Rev: C1	
Cad Ref: A-101-P11	Drawn: PH	Team: -